

**comaro**

**LB 2,2 – 5.5 200 L + Dryer**  
Compressore a vite – Screw compressor

**Installation plan**  
Schema di installazione

UTP 20 - 001

Rev.1 del 02/2015

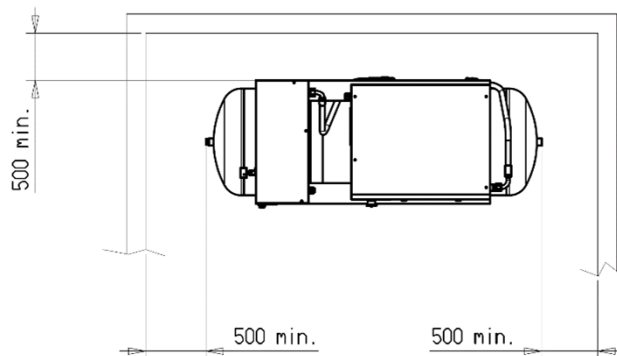
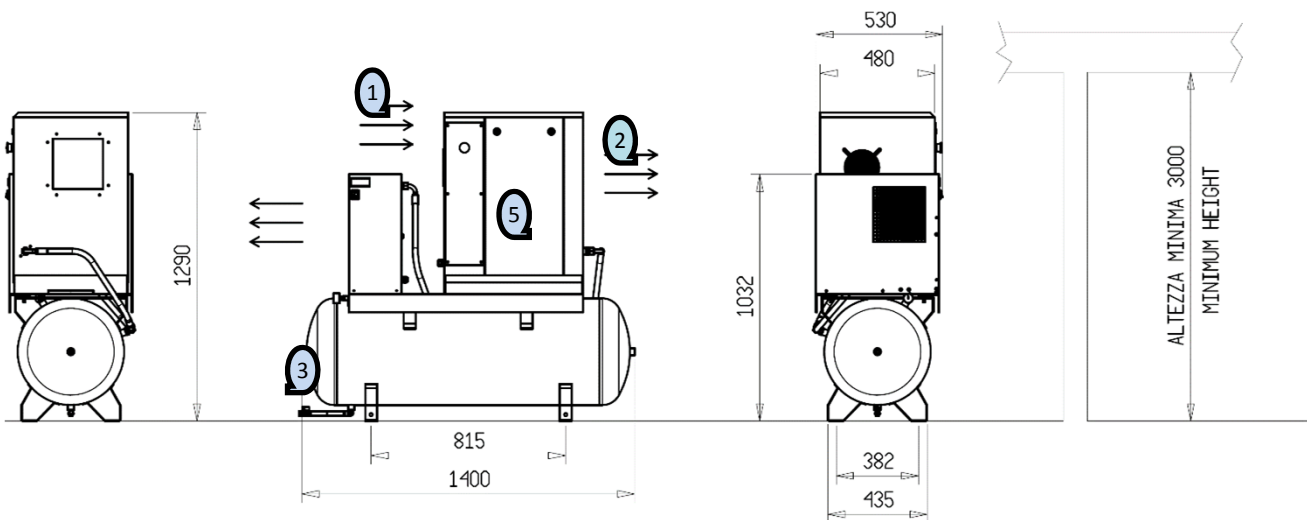

- 1) Cooling air inlet  
Ingresso aria di raffreddamento
- 2) Cooling air outlet  
Uscita aria di raffreddamento
- 3) Compressed air connection  
Connessione aria compressa
- 4) Power supply  
Alimentazione elettrica
- 5) Service side  
Lato manutenzione

Type	L	B	H	a	b	c	d	e	f	Rated motor power Potenza motore	Weight Peso	Cooling air flow Portata aria di raffreddamento	Cooling air outlet cross section Area uscita aria di raffreddamento	Compressed air connection Connessione aria compressa
LB	mm	mm	mm	mm	mm	mm	mm	mm	mm	kW	kg	m <sup>3</sup> /h	m <sup>2</sup>	G
2,2	1440	510	1280	51.5	697	382	815	230	230	2,2	193	600	0.053	1/2"
3	1440	510	1280	51.5	697	382	815	230	230	3	201	600	0.053	1/2"
4	1440	510	1280	51.5	697	382	815	230	230	4	204	600	0.053	1/2"
5.5	1440	510	1280	51.5	697	382	815	230	230	5.5	206	600	0.053	1/2"